

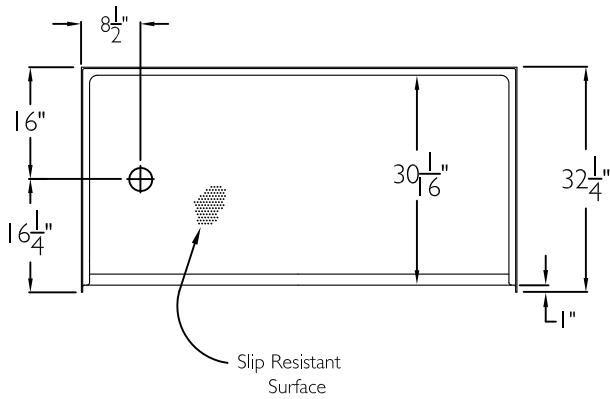

TOP VIEW

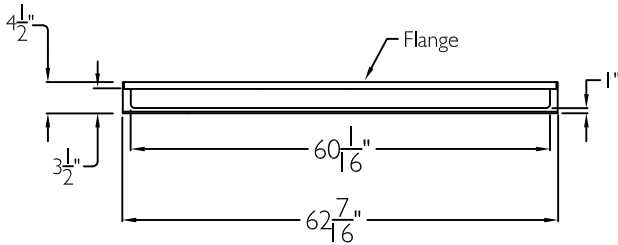

FRONT VIEW



SIDE VIEW

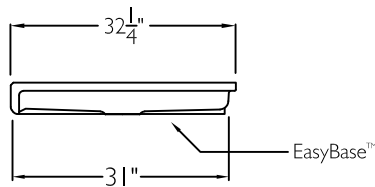

CROSS SECTION OF THRESHOLD

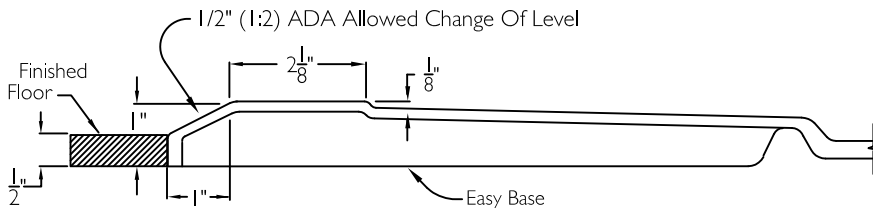

## SUBMITTAL

This shower enclosure shall be model SSB 6232 BF 1.0 Base left or right drain. Finished surface shall be of a sanitary grade solid surface exhibiting a minimal thickness of 55 dry mils and a finished cured Barcoal hardness of 80-90 as tested with ASTM D-2583. Unit construction shall be of a molded reinforced fiberglass with a 15% minimum fiberglass content.

The unit shall have outside dimensions of 62 7/16" x 32 1/4" x 4 1/2" with a one inch Change Of Level threshold.

The unit shall meet ANSI Z124.1-2, BOCA, UPC, CSA, Home Innovation Research Lab, ADA, ANSI A117.1, and shall meet the requirements of the Southern Building Code.

HANDED BY THE DRAIN.

The enclosure shall be equipped with the following features:

- 1) One inch Change Of Level Threshold,
- 2) EasyBase™ self sustaining bottom,
- 3) Slip resistant surface on floor,
- 4) Solid Surface finish.
- 5) Left or right drain location.

THIS UNIT FEATURES THE OUTSIDE DIMENSIONS OF 62 7/16" AND 32 1/4". FINISHED WALLS ABOVE THE SHOWER BASE BY OTHERS.

THIS SHOWER BASE IS AVAILABLE WITH SECTIONAL WALL SYSTEM MODEL: SST 6232 BF 1.0 L-R 5P.

|  |                        |   |   |              |
|--|------------------------|---|---|--------------|
| Job Name   | Approved By Print Name | Date  | COMFORT DESIGNS                               |              |
| Project No   | Approved By Signature  |   | Model No. SSB 6232 BF 1.0 COL L-R Base-I      |              |
| Comfort Designs<br>435 Industrial Road<br>Savannah, TN 38372<br>tel 800.443.7269<br>fax 731.925.4290<br>www.comfortdesignsbathware.com | Architect              |   | Drawing No. SSB 6232 BF 1.0 COL L-R Easy Base |              |
|  | Engineer               |   | Date Issued. 6-23-14                          | Drawing Rev. |
|  | Rep                    |   | Material. Solid Surface                       |              |
|  | Wholesaler             |   | Color.  |              |
|  | Comments               | Dimensions are in inches. Due to the nature of the materials dimensions may vary ± 1/2" |   |              |